



TRAINING COURSE OUTLINE

**ANNEX A
PERSONNEL AND EQUIPMENT**

ANNEX A
PERSONNEL AND EQUIPMENT

TABLE OF CONTENTS

TABLE OF CONTENTS	2
REVISION PAGE.....	3
LIST OF EFFECTIVE PAGES	4
PERSONNEL AND EQUIPMENT.....	5
NEWBERG, OREGON	8
KLAMATH FALLS, OREGON.....	9
SIMULATORS	11

ANNEX A
PERSONNEL AND EQUIPMENT

LIST OF EFFECTIVE PAGES

Pg	Title	Date	Rev
1	Title Page	08/31/2017	0
2	Table of Contents	08/15/2019	4
3	Revision Page	08/15/2019	4
4	List of Effective Pages	08/15/2019	4
5	Overview, Training Requirements, Personnel, and Qual.	08/15/2019	4
6	Helicopter Qualifications Table	08/15/2019	4
7	Airplane Qualifications Table	08/15/2019	4
8	Classrooms and Equipment	08/15/2019	4
9	Classrooms and Equipment (Cont)	08/15/2019	4
10	Approved Aircraft Table	08/15/2019	4
11	Simulators	08/15/2019	4

FAA APPROVED	
Signature:	<u>Joseph P. Mollahan</u>
Inspector Name:	<u>Joseph P. Mollahan</u>
Effective Date:	<u> </u> /2019
Office Designator:	<u>NM-FSDO-09</u>

ANNEX A
PERSONNEL AND EQUIPMENT

PERSONNEL AND EQUIPMENT

1. **Overview:** The purpose of this document is to provide an overview of training personnel and equipment in accordance with FAR §141.55. It details who holds each position, who is qualified to teach which course and in which aircraft, details all equipment, aircraft and simulators used for flight training. It refers to individual Training Course Outlines (TCOs) and should be read in conjunction with those TCOs.
2. **Training Requirements:** All instructors will undergo annual Part 141 refresher training so satisfy the requirements of FAR §141.79. The relevant Chief Flight Instructor is responsible for the conduct and record keeping of such training.
3. **Personnel and Qualifications:**

Director of Training: The Director of Training (DOT) is responsible for the oversight and regulatory compliance of all training including personnel, equipment and facilities. The DOT must hold as a minimum, a Commercial Pilot certificate with Instructor and Instrument privileges (in any Category and Class).

Chief Flight Instructor: The Chief Flight Instructor is responsible for ensuring that FAR §141.85 Chief Instructor Responsibilities are met. The Chief Flight Instructor must hold as a minimum a Commercial Pilot Certificate, with a current flight instructor certificate. The certificates must contain the appropriate category and class used in the course and an instrument rating, if the rating is required. The Chief Flight Instructor must meet the experience requirements stipulated under FAR §141.35.

Assistant Chief Flight Instructor: The Assistant Chief Flight Instructor responsibilities will be delegated by the Chief Flight Instructor. The Assistant Chief Flight Instructor must hold as a minimum a Commercial Pilot Certificate, with a current flight instructor certificate. The certificates must contain the appropriate category and class used in the course and an instrument rating, if the rating is required. The Chief Flight Instructor must meet the experience requirements stipulated under FAR §141.36.

Check Instructor: Experienced Instructors may hold the qualification of Check Instructor and conduct the various stage checks as detailed in relevant TCO's. Check Instructors undergo training as prescribed by FAR §141.37.

Line Instructor: A Line Instructors primary duty is to carry out flight and ground instruction in accordance with relevant TCO's or Training Plans. As a minimum, Line Instructors must hold a Commercial Pilot Certificate, and a current flight instructor certificate. The certificates must contain the appropriate category and class used in the course and an instrument rating, if the rating is required.

Ground Instructor. Ground Instructors must meet the requirements of FAR §141.81.

ANNEX A
PERSONNEL AND EQUIPMENT

HELICOPTER QUALIFICATIONS TABLE

Relevant Courses/Ratings Rotorcraft – Helicopter

1. Private Pilot
2. Instrument Rating
3. Commercial Pilot
4. Certified Flight Instructor
5. Certified Flight Instructor Instrument Rating
6. Special Curricula Course – Commercial Instrument
7. Special Preparation Course – Turbine Transition
8. Special Preparation Course – External Load
9. Special Preparation Course – VFR Refresher

Chief Instructor: Matthew VanPelt, (352) 552-2551
Assistant Chief Instructor: Keyan Robles (503) 989-0974

Primary Location: Newberg, OR
Primary Location: Klamath Falls, OR

Name	Cert. #	Line Instructor	Check Instructor	Assistant Chief Instructor	Chief Instructor
Matthew VanPelt*	3375464	X	X	X	1,2,3,4,5,6,7,8,9
Avery Kunz	3628548	X	1,2,3,4,5,6,9		
Keyan Robles	3771924	X	X	1,2,3,4,5,6,9	
Tyler Sturdevant	3060998	X	1,2,3,4,5,6,7,8,9		
Lars Mehlum	3778024	X	1,2,3,4,5,6,9		
Trent Vick	3770394	X	1,2,3,4,5,6,7,9		
Henry Sexsmith	3717366	1,2,3,5,6,9			
Ty Burlingham	3170566	1,2,3,4,5,6,7,8,9			
Jordan Willburn	3698605	1,2,3,5,6,9			
Kevin Taff	3849894	1,3,9			

* Denotes Director of Training. X denotes authorization with additional role. # Ground Instructor Only

ANNEX A
PERSONNEL AND EQUIPMENT

4. Classrooms, Briefing Areas, Flight Planning Areas and Equipment: The following diagrams represent the floor plans of classrooms, briefing and flight planning areas at their respective locations. Each classroom is furnished with tables and chairs, whiteboard and markers, computer and screen and is used for the purpose of delivering ground instruction. Briefing areas are used for the purpose of pre/post flight briefing and are equipped with a desks and chairs. Flight Planning areas are equipped with a desk and internet computer and are used for the purpose of flight planning. Weather briefings and NOTAMs can be obtained through either the internet or briefing office via telephone. Other flight planning information and equipment is provided in this area such as weight and balance information, navigation log cards and risk assessment tools. The maximum number of personnel permitted in each space is annotated on the plan in accordance with FAR §141.55.

NEWBERG, OREGON

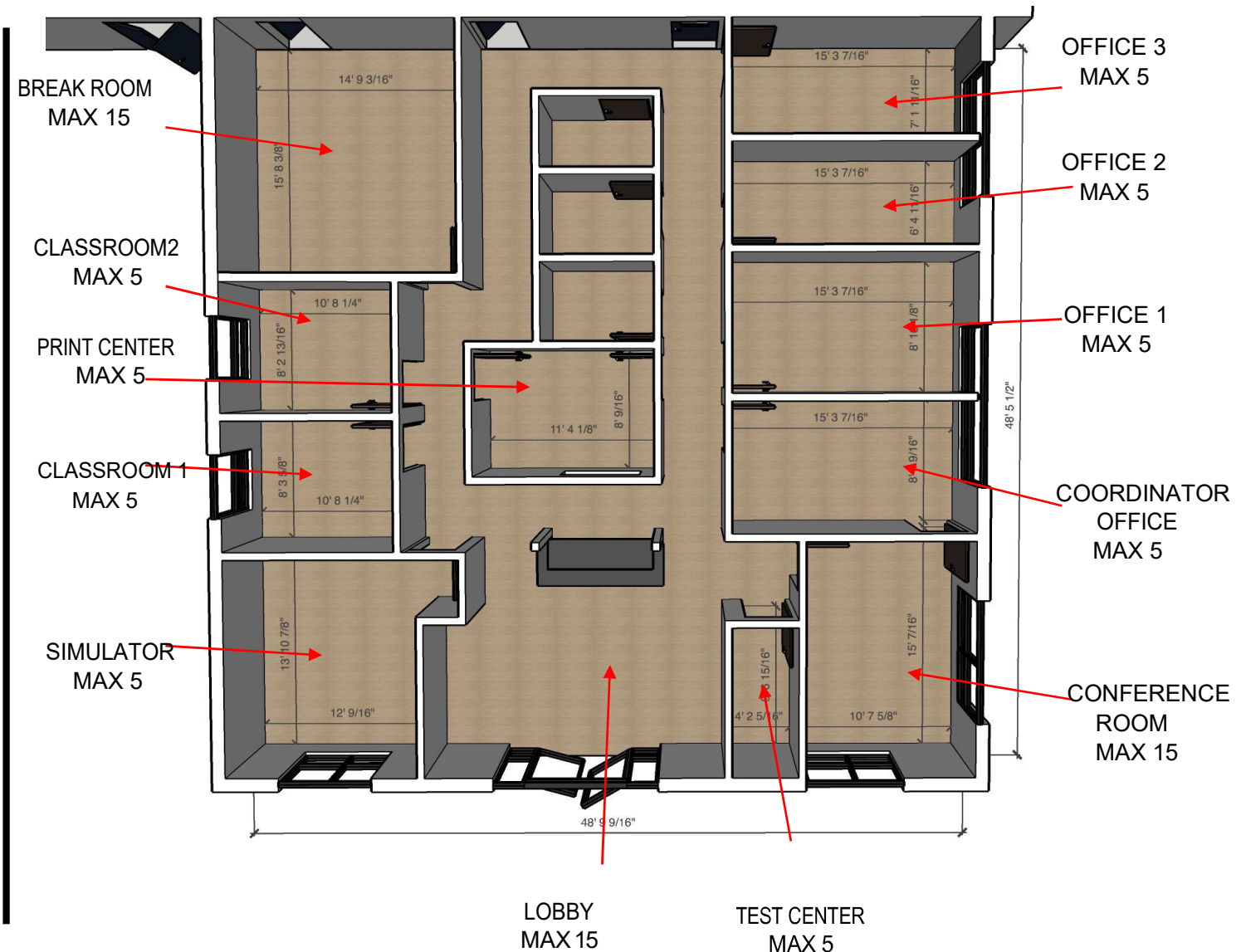

ANNEX A
PERSONNEL AND EQUIPMENT

KLAMATH FALLS, OREGON

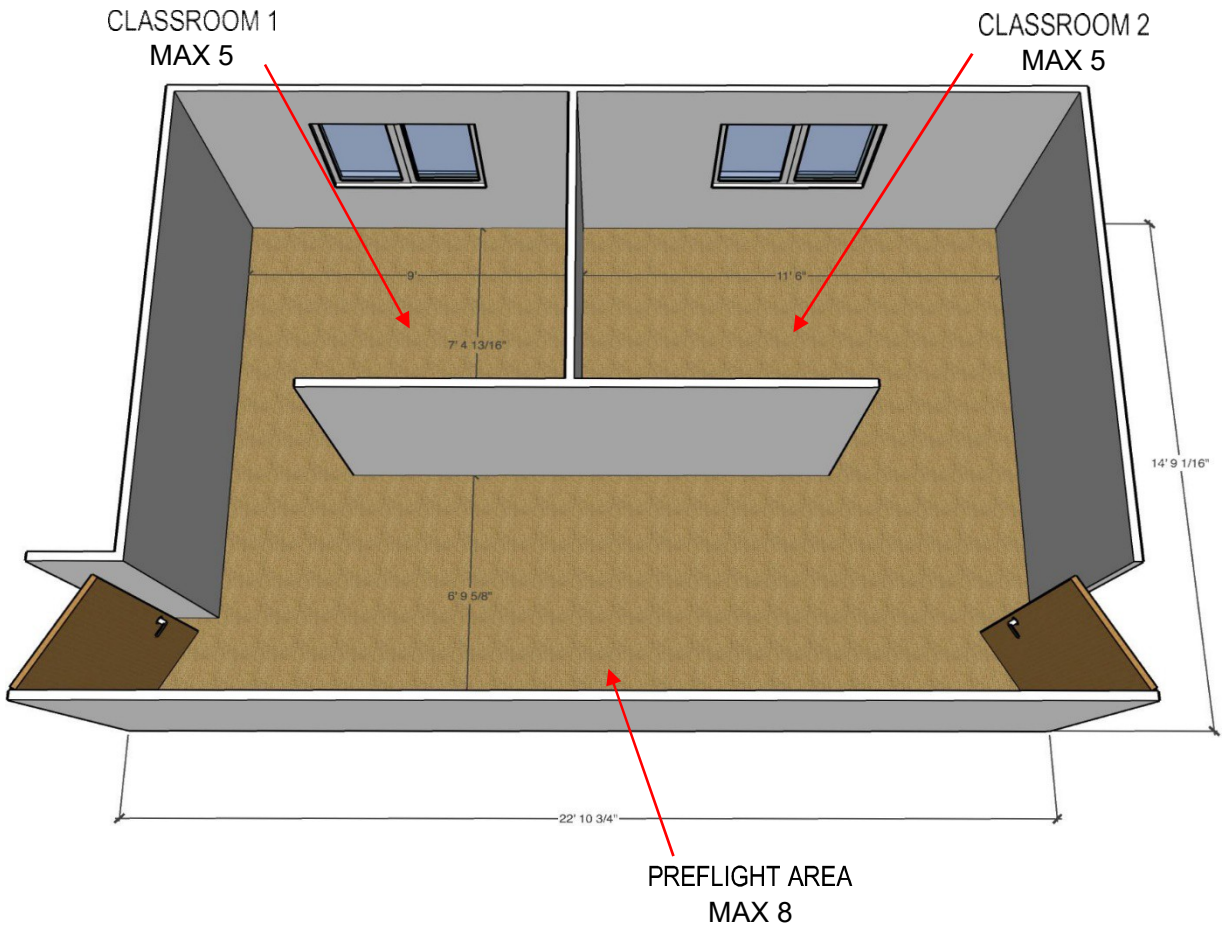

ANNEX A
PERSONNEL AND EQUIPMENT

5. Approved Aircraft: The following tables detail the aircraft used for delivering flight instruction. All aircraft used under Part 141 meet the provisions of FAR §141.39:

ROTORCRAFT - HELICOPTER		
Courses (includes additional ratings)	Aircraft	Simulator
Private Pilot Instrument Rating Commercial Pilot Certified Flight Instructor Certified Flight Instructor Instrument Rating Special Curricula Course – Commercial Instrument Special Preparation Course – VFR Refresher	Cabri G2 B206B3/L4 AS350B2/B3/B3e	N/A
Special Preparation Course - Turbine Transition	B206B3/L4 AS350B2/B3/B3e	N/A
Special Preparation Course - External Load	B206B3/L4 AS350B2/B3/B3e	N/A

* Special equipment includes Lines, Hooks, Loads, Attaching Equipment, Fire Buckets, and Cameras when necessary to complete lesson objectives

AIRPLANE - SEL		
Courses (includes additional ratings)	Aircraft	Simulator
Private Pilot Instrument Rating Commercial Pilot Certified Flight Instructor Certified Flight Instructor Instrument Special Curricula Course – Commercial Instrument	C-172 N/M PA-28R-200	N/A

ANNEX A
PERSONNEL AND EQUIPMENT

SIMULATORS

Upon approval, Precision Aviation Training will add the following training device to their authorized equipment list.

Redbird Flight Simulations, Inc. Model TD2
Airplane Single Engine Land
Basic Aviation Training Device (BATD)

The device is physically located in the designated simulator room of the Newberg facility.

In accordance with the letter dated October 24, 2018 the device is authorized for use within guidelines, and Precision Aviation Training will be adding guidelines to its Airplane Single Engine Land curricula only.